

# 7500/3/HS OPERATING INSTRUCTIONS

## Introduction

The 7500/3/HS is a hand held panic alarm transmitter that can also be worn on the belt, or located in a fixed position using a mounting bracket.

The 7500/3/HS transmitter has been specifically tailored for HSBC operation. Please see the Transmitter Operation section for full details.

Refer to the Iris+ Installation Guide (MK192) for details on adding the device to the system.

## Transmitter Switch Settings

The 7500/3/HS transmitter has 6 internal switches located under the battery cover, as shown below. The following table outlines the available settings.

**Note: All greyed out options above should be left unchanged (in the OFF position).**

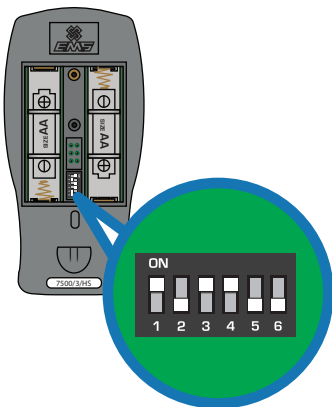

Switch No	Function	OFF Position	ON Position
1	Vibrate confirmation	Vibrate disabled	Vibrate enabled
2	Panel compatibility	Iris+	DO NOT USE
3	Man down enable	Standard operation (disabled)	DO NOT USE
4	Call-in transmission	Call-in disabled	Call-in enabled
5	Button timing	Standard mode	DO NOT USE
6	Enhanced configuration	Standard operation	DO NOT USE

## Transmitter Operation

The 7500/3/HS transmitter when set for **opposed action** alarm activation, is outlined below:

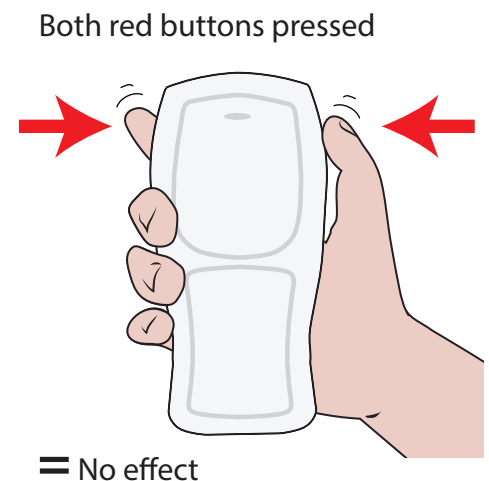
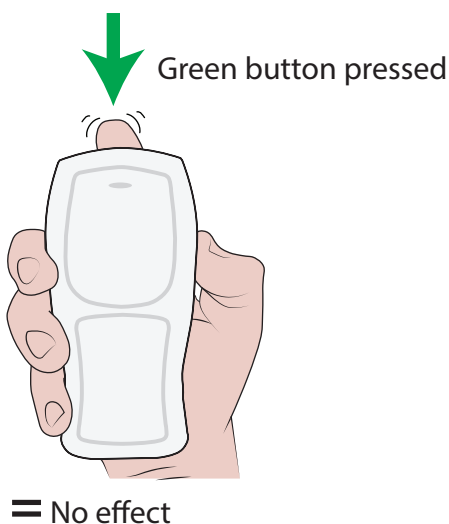

**Continued overleaf...**

Continued...

Green button pressed  
(for 2 seconds)

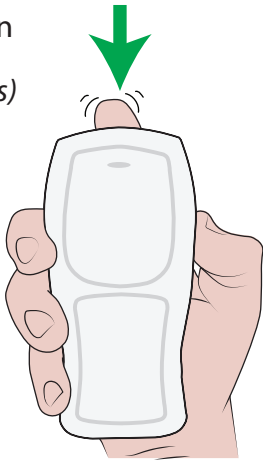

Local alarm initiated

One red button pressed  
(for 2 seconds)

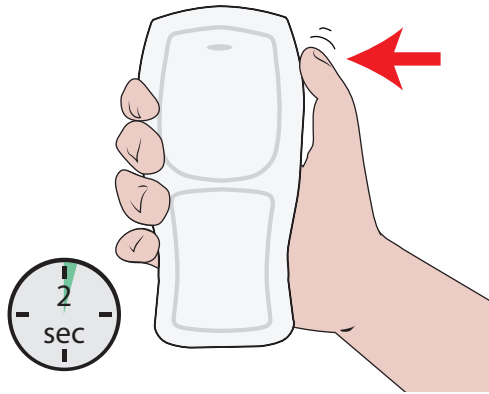

No effect

Both red buttons  
(for 2 seconds)

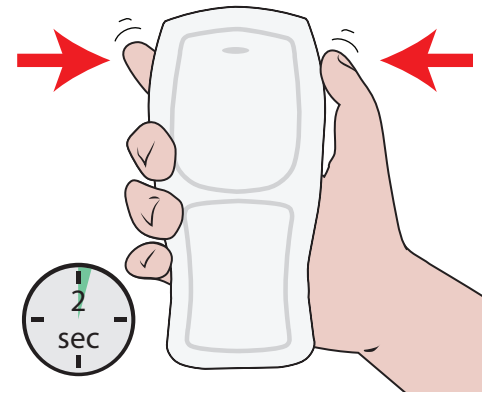

Full alarm initiated

## Alarm Latch Memory

The red LED illuminating as shown, upon a single red button, indicates that a full alarm has been initiated from the hand push within the last 24 hours.

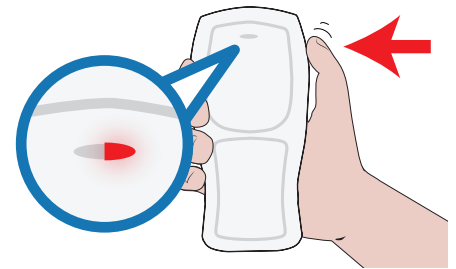

## Battery Low Indication

The yellow LED illuminating as shown, upon a single red button, indicates that the batteries voltage in the handpush is low.

This information will also be reported on the Iris+ LCD display.

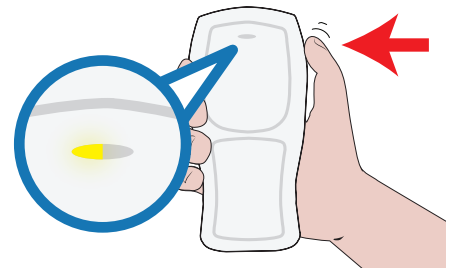

## Battery Replacement

The 7500/3/HS transmitter requires 2x AA Alkaline (Panasonic LR6AD Powerline / Varta 4006 Industrial) batteries. Only use specified batteries.

Carefully replace batteries, whilst observing correct polarity.

After replacing the batteries, the device must be retested to guarantee correct battery fitting and device functionality.

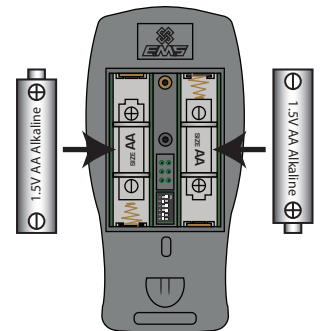

**OBSERVE CORRECT POLARITY!**



EMS Ltd.  
Technology House  
Sea Street, Herne Bay,  
Kent, CT6 8JZ.

t: +44 (0) 1227 369570

f: +44 (0) 1227 369679

[www.emsgroup.co.uk](http://www.emsgroup.co.uk)