

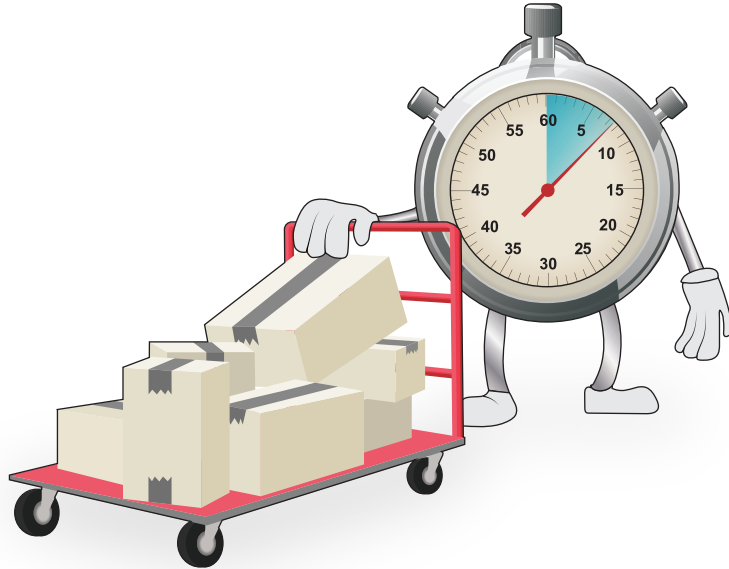

# FireCell

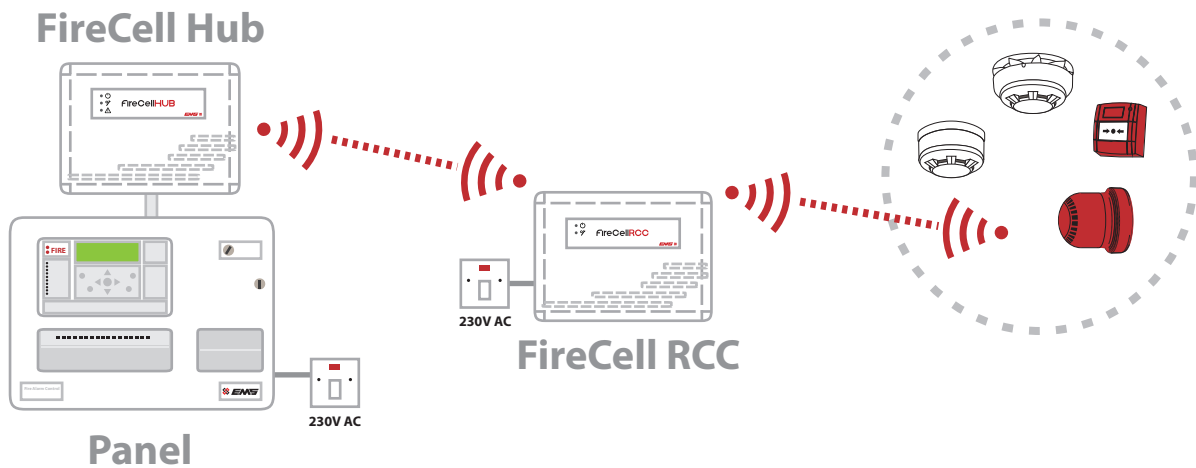

## QUICK START GUIDE



# FireCell Guide

*FREE mobile phone app*

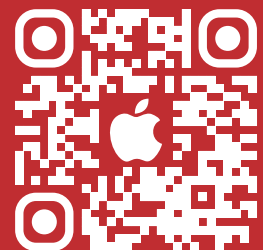
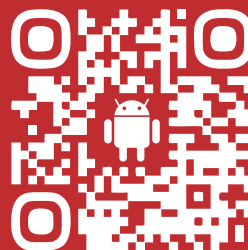

# Introduction

This guide covers the installation of both programmed and un-programmed systems. More detailed manuals have been supplied in the FireCell Instruction Pack within the control panel packaging.

Programming can be achieved either **manually** or via **computer programs**.

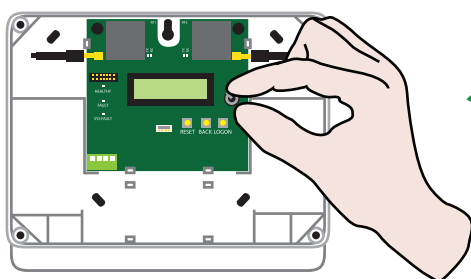

Software is freely available from our website [www.emsgroup.co.uk](http://www.emsgroup.co.uk)

## Important notes

If your system has been supplied fully **programmed**, please be aware of the following points:-

- A text address schedule will be supplied with the Control Panel packaging detailing device locations and address numbers.
- **All products** will be labelled with their associated address numbers so must be installed in their correct locations.
- **DO NOT** press the device logon buttons if the system is supplied this way. Doing this will un-programme the device from the system.

FIRECELL PANEL - Loop 1 (68 Devices)					
Address	Name	Type	Zone	Action	Text
001.00	Call Point FireCell	Call Point	01	Fire	CP GF UNIT 1

[FILTERS] Name: Loop 1 (10 Devices)						
Address	Device	Type	State	Action	Text	
001:00	Call Point Freq-C	Call Point	On	Fire	CFP-001	
001:00	Call Point Freq-C	Call Point	On	Fire	CFP-002	
001:00	Call Point Freq-C	Call Point	On	Fire	CFP-003	
001:00	Call Point Freq-C	Call Point	On	Fire	CFP-004	
001:00	Call Point Freq-C	Call Point	On	Fire	CFP-005	
001:00	Call Point Freq-C	Call Point	On	Fire	CFP-006	
001:00	Call Point Freq-C	Call Point	On	Fire	CFP-007	
001:00	Call Point Freq-C	Call Point	On	Fire	CFP-008	
001:00	Call Point Freq-C	Call Point	On	Fire	CFP-009	
001:00	Call Point Freq-C	Call Point	On	Fire	CFP-010	
001:00	Call Point Freq-C	Call Point	On	Fire	CFP-011	
001:00	Call Point Freq-C	Call Point	On	Fire	CFP-012	
001:00	Call Point Freq-C	Call Point	On	Fire	CFP-013	
001:00	Call Point Freq-C	Call Point	On	Fire	CFP-014	
001:00	Call Point Freq-C	Call Point	On	Fire	CFP-015	
001:00	Call Point Freq-C	Call Point	On	Fire	CFP-016	
001:00	Call Point Freq-C	Call Point	On	Fire	CFP-017	
001:00	Call Point Freq-C	Call Point	On	Fire	CFP-018	
001:00	Call Point Freq-C	Call Point	On	Fire	CFP-019	
001:00	Call Point Freq-C	Call Point	On	Fire	CFP-020	
001:00	Call Point Freq-C	Call Point	On	Fire	CFP-021	
001:00	Call Point Freq-C	Call Point	On	Fire	CFP-022	
001:00	Call Point Freq-C	Call Point	On	Fire	CFP-023	
001:00	Call Point Freq-C	Call Point	On	Fire	CFP-024	
001:00	Call Point Freq-C	Call Point	On	Fire	CFP-025	
001:00	Call Point Freq-C	Call Point	On	Fire	CFP-026	
001:00	Call Point Freq-C	Call Point	On	Fire	CFP-027	
001:00	Call Point Freq-C	Call Point	On	Fire	CFP-028	
001:00	Call Point Freq-C	Call Point	On	Fire	CFP-029	
001:00	Call Point Freq-C	Call Point	On	Fire	CFP-030	



EN54-25:2008  
Technical Data see Installation guide



## Step 1 - Install the panel & hub

If the site has been surveyed, the location of the units will be indicated on the survey report located within the control panel packaging.

See FireCell Instruction Pack for more information.

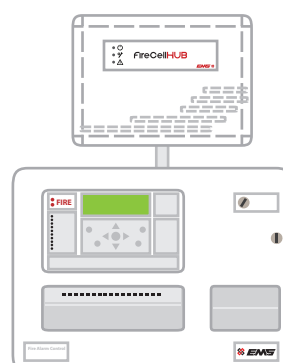

Hub

## Panel

## Step 2 - Install the RCCs

The survey report will also detail the locations of the RCCs.

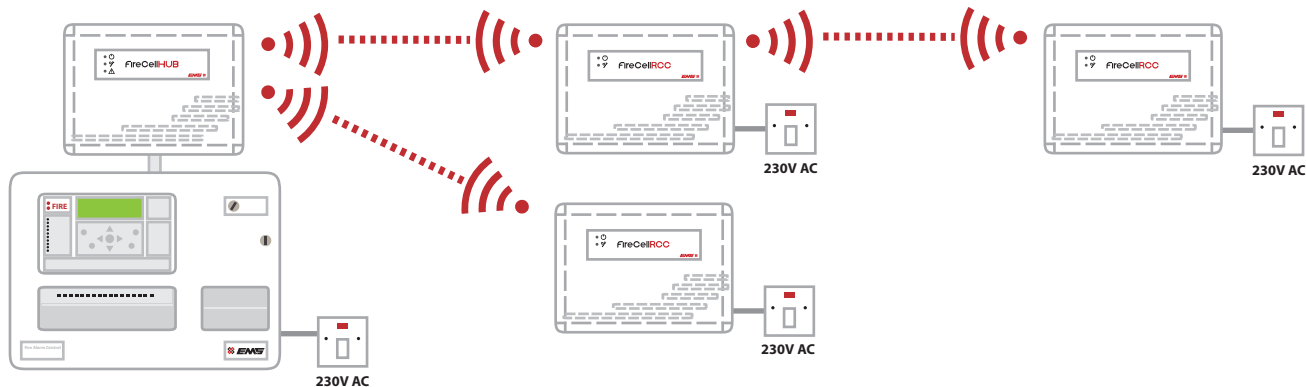

See FireCell Instruction Pack for more information.

## Step 3 - Log on the RCCs

**Go to Step 4 if the system has been supplied fully programmed.**

The RCCs can be logged on to the system using the RCC's ident number which is located on the side of the unit.

See FireCell Instruction Pack for more information.



## Step 4 - Power up the devices

Detectors, Sounders, Call Points and Input/Output Units have power jumpers as shown:

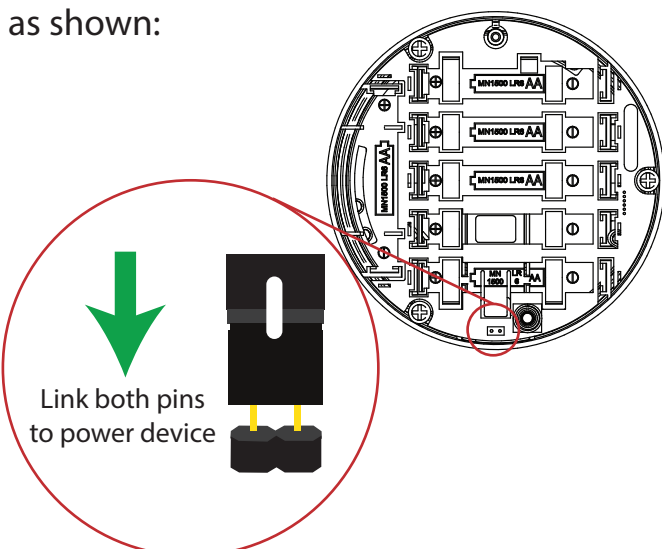

Combined Sounder Detectors are powered by changing the orientation of the switch P as shown:

**Switch P ON = POWER ON**

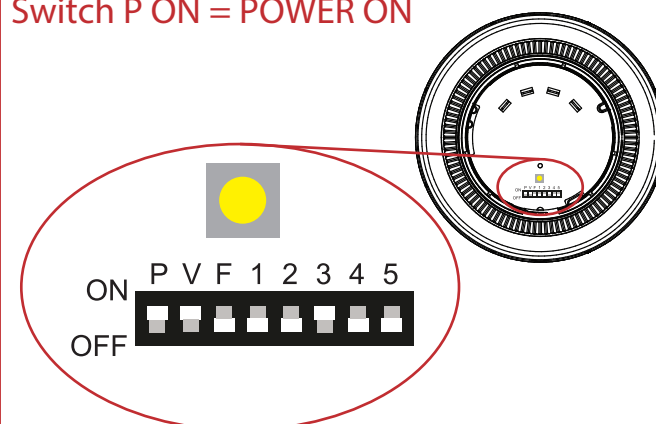

## Step 5 - Log on the radio devices

**Go to Step 6 if the system has been supplied fully programmed.**

The device can now be logged on to the system. This can be achieved using the log on button or ident method. The log on button is located inside the unit.

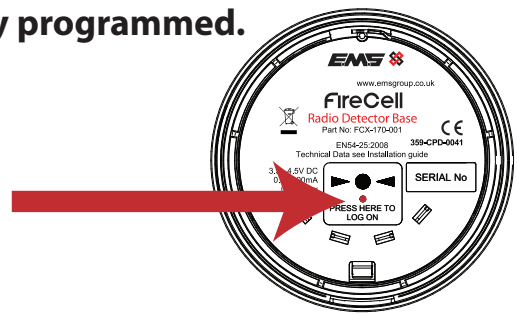

See FireCell Instruction Pack for more information

## Step 6 - Install the devices

**Note:** When installing Combined Sounder Detectors, it is important that the tamper alignment markers are properly positioned to ensure correct operation and to prevent unnecessary tamper faults.

See FireCell Instruction Pack for more information.

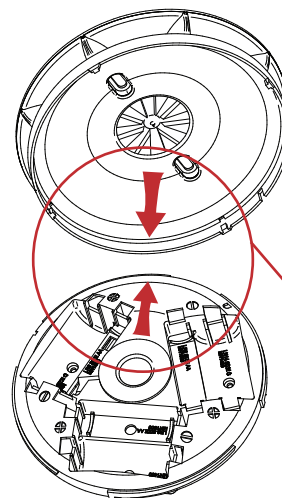

Align tamper arrows **THEN** turn to lock into place

## Step 7 - Program the panel

**Note: This step is not necessary if the system has been supplied fully programmed.**

The Hub, RCCs and all radio devices must now be added to the panel ensuring the loop number and addresses programmed at the FireCell Hub correspond to that programmed at the panel. This can also be achieved using the Loop Explorer computer program.

See FireCell Instruction Pack for more information.



Technology House  
Sea Street  
Herne Bay, Kent  
CT6 8JZ  
[emsgroup.co.uk/contact](http://emsgroup.co.uk/contact)

Contact us

