

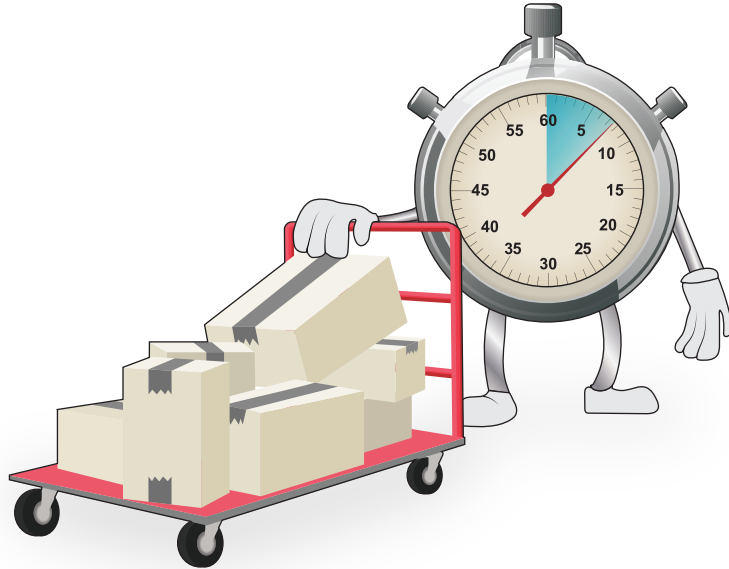

FireCell

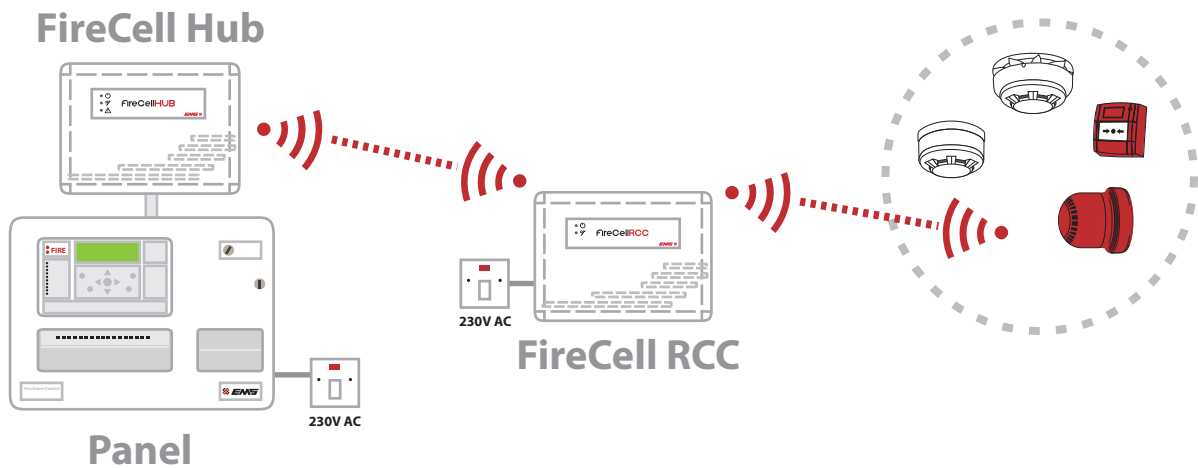

QUICK START GUIDE



FireCell Guide

FREE mobile phone app

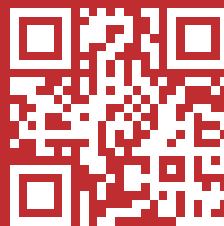

Android

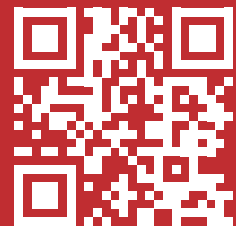

iPhone

Introduction

This guide covers the installation of both programmed and un-programmed systems. More detailed manuals have been supplied in the FireCell Instruction Pack within the control panel packaging.

Programming can be achieved either **manually** or via **computer programs**.

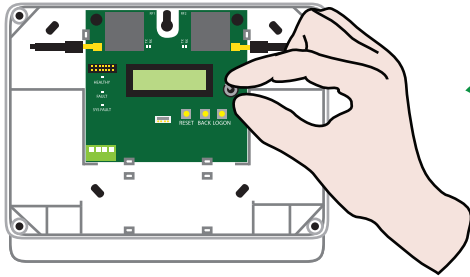

Software is freely available from our website www.emsgroup.co.uk

⚠ Important notes

If your system has been supplied fully **programmed**, please be aware of the following points:-

- A text address schedule will be supplied with the Control Panel packaging detailing device locations and address numbers.
- **All products** will be labelled with their associated address numbers so must be installed in their correct locations.
- **DO NOT** press the device logon buttons if the system is supplied this way. Doing this will un-programme the device from the system.

FIRECELL PANEL - Loop 1 (68 Devices)					
Address	Name	Type	Zone	Action	Text
001.00	Call Point FireCell	Call Point	01	Fire	CP GF UNIT 1

FIRECELL PANEL - Loop 1 (68 Devices)					
Address	Name	Type	Zone	Action	Text
001.00	Call Point FireCell	Call Point	01	Fire	CP GF UNIT 1
001.01	Call Point FireCell	Call Point	01	Fire	CP GF UNIT 1
001.02	Call Point FireCell	Call Point	01	Fire	CP GF UNIT 1
001.03	Call Point FireCell	Call Point	01	Fire	CP GF UNIT 1
001.04	Call Point FireCell	Call Point	01	Fire	CP GF UNIT 1
001.05	Call Point FireCell	Call Point	01	Fire	CP GF UNIT 1
001.06	Call Point FireCell	Call Point	01	Fire	CP GF UNIT 1
001.07	Call Point FireCell	Call Point	01	Fire	CP GF UNIT 1
001.08	Call Point FireCell	Call Point	01	Fire	CP GF UNIT 1
001.09	Call Point FireCell	Call Point	01	Fire	CP GF UNIT 1
001.10	Call Point FireCell	Call Point	01	Fire	CP GF UNIT 1
001.11	Call Point FireCell	Call Point	01	Fire	CP GF UNIT 1
001.12	Call Point FireCell	Call Point	01	Fire	CP GF UNIT 1
001.13	Call Point FireCell	Call Point	01	Fire	CP GF UNIT 1
001.14	Call Point FireCell	Call Point	01	Fire	CP GF UNIT 1
001.15	Call Point FireCell	Call Point	01	Fire	CP GF UNIT 1
001.16	Call Point FireCell	Call Point	01	Fire	CP GF UNIT 1
001.17	Call Point FireCell	Call Point	01	Fire	CP GF UNIT 1
001.18	Call Point FireCell	Call Point	01	Fire	CP GF UNIT 1
001.19	Call Point FireCell	Call Point	01	Fire	CP GF UNIT 1
001.20	Call Point FireCell	Call Point	01	Fire	CP GF UNIT 1
001.21	Call Point FireCell	Call Point	01	Fire	CP GF UNIT 1
001.22	Call Point FireCell	Call Point	01	Fire	CP GF UNIT 1
001.23	Call Point FireCell	Call Point	01	Fire	CP GF UNIT 1
001.24	Call Point FireCell	Call Point	01	Fire	CP GF UNIT 1
001.25	Call Point FireCell	Call Point	01	Fire	CP GF UNIT 1
001.26	Call Point FireCell	Call Point	01	Fire	CP GF UNIT 1
001.27	Call Point FireCell	Call Point	01	Fire	CP GF UNIT 1
001.28	Call Point FireCell	Call Point	01	Fire	CP GF UNIT 1
001.29	Call Point FireCell	Call Point	01	Fire	CP GF UNIT 1
001.30	Call Point FireCell	Call Point	01	Fire	CP GF UNIT 1
001.31	Call Point FireCell	Call Point	01	Fire	CP GF UNIT 1
001.32	Call Point FireCell	Call Point	01	Fire	CP GF UNIT 1
001.33	Call Point FireCell	Call Point	01	Fire	CP GF UNIT 1
001.34	Call Point FireCell	Call Point	01	Fire	CP GF UNIT 1
001.35	Call Point FireCell	Call Point	01	Fire	CP GF UNIT 1
001.36	Call Point FireCell	Call Point	01	Fire	CP GF UNIT 1
001.37	Call Point FireCell	Call Point	01	Fire	CP GF UNIT 1
001.38	Call Point FireCell	Call Point	01	Fire	CP GF UNIT 1
001.39	Call Point FireCell	Call Point	01	Fire	CP GF UNIT 1
001.40	Call Point FireCell	Call Point	01	Fire	CP GF UNIT 1
001.41	Call Point FireCell	Call Point	01	Fire	CP GF UNIT 1
001.42	Call Point FireCell	Call Point	01	Fire	CP GF UNIT 1
001.43	Call Point FireCell	Call Point	01	Fire	CP GF UNIT 1
001.44	Call Point FireCell	Call Point	01	Fire	CP GF UNIT 1
001.45	Call Point FireCell	Call Point	01	Fire	CP GF UNIT 1
001.46	Call Point FireCell	Call Point	01	Fire	CP GF UNIT 1
001.47	Call Point FireCell	Call Point	01	Fire	CP GF UNIT 1
001.48	Call Point FireCell	Call Point	01	Fire	CP GF UNIT 1
001.49	Call Point FireCell	Call Point	01	Fire	CP GF UNIT 1
001.50	Call Point FireCell	Call Point	01	Fire	CP GF UNIT 1
001.51	Call Point FireCell	Call Point	01	Fire	CP GF UNIT 1
001.52	Call Point FireCell	Call Point	01	Fire	CP GF UNIT 1
001.53	Call Point FireCell	Call Point	01	Fire	CP GF UNIT 1
001.54	Call Point FireCell	Call Point	01	Fire	CP GF UNIT 1
001.55	Call Point FireCell	Call Point	01	Fire	CP GF UNIT 1
001.56	Call Point FireCell	Call Point	01	Fire	CP GF UNIT 1
001.57	Call Point FireCell	Call Point	01	Fire	CP GF UNIT 1
001.58	Call Point FireCell	Call Point	01	Fire	CP GF UNIT 1
001.59	Call Point FireCell	Call Point	01	Fire	CP GF UNIT 1
001.60	Call Point FireCell	Call Point	01	Fire	CP GF UNIT 1

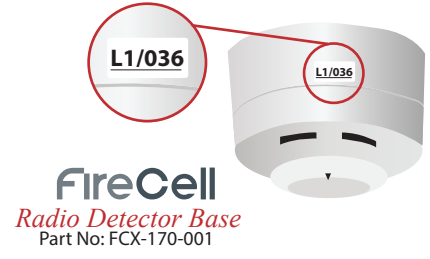

EN54-25:2008
Technical Data see Installation guide



Step 1 - Install the panel & hub

If the site has been surveyed, the location of the units will be indicated on the survey report located within the control panel packaging.

See FireCell Instruction Pack for more information.

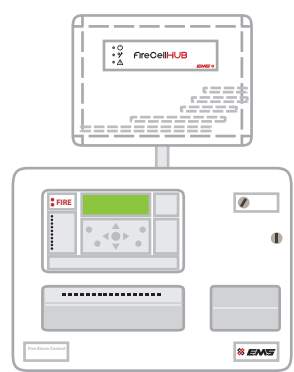

Hub

Panel

Step 2 - Install the RCCs

The survey report will also detail the locations of the RCCs.

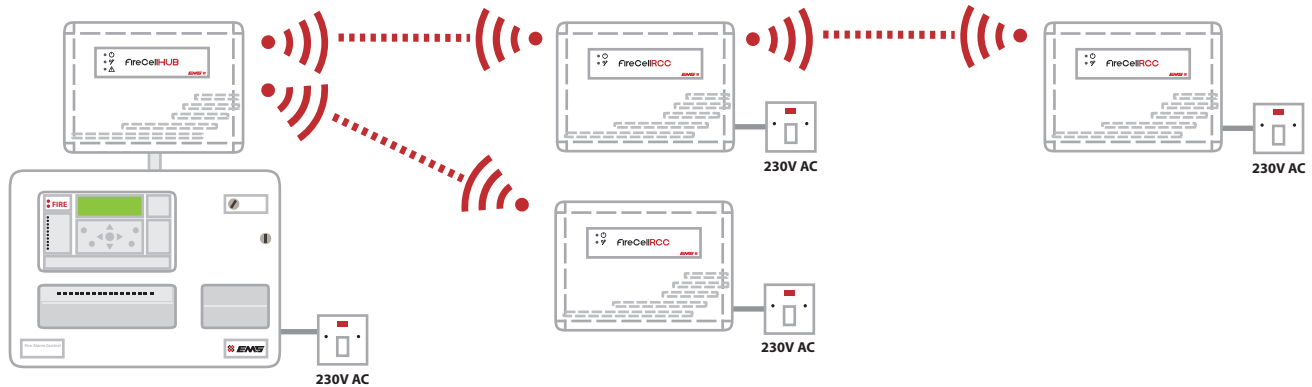

See FireCell Instruction Pack for more information.

Step 3 - Log on the RCCs

Go to Step 4 if the system has been supplied fully programmed.

The RCCs can be logged on to the system using the RCC's ident number which is located on the side of the unit.

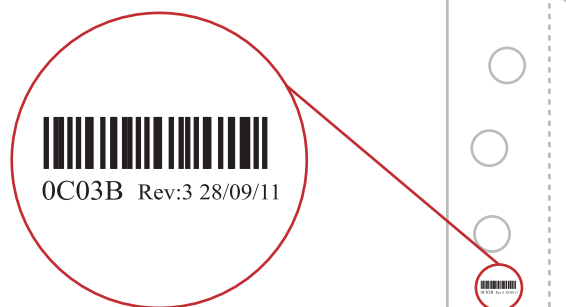

See FireCell Instruction Pack for more information.

Step 4 - Power up the devices

Detectors, Sounders, Call Points and Input/Output Units have power jumpers as shown:

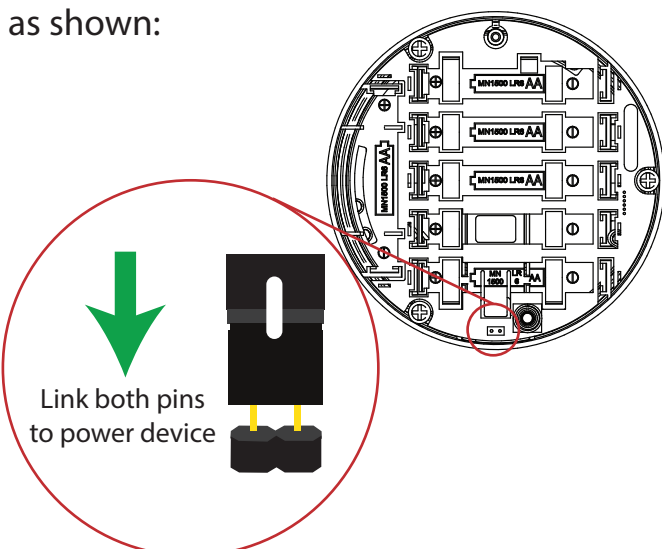

Combined Sounder Detectors are powered by changing the orientation of Switch 1 as shown:

Switch 1 on = POWER ON

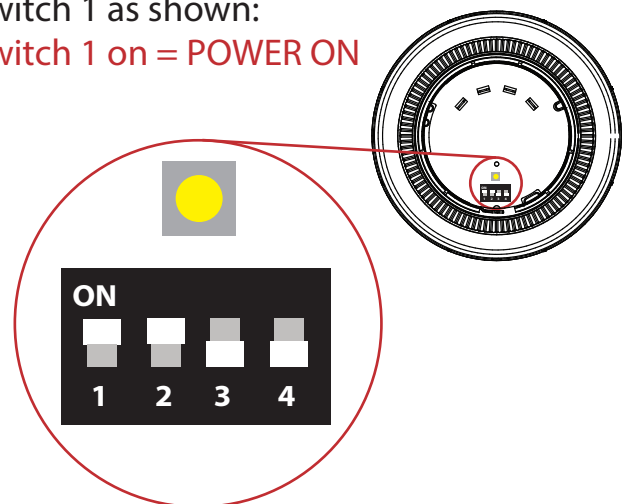

Step 5 - Log on the radio devices

Go to Step 6 if the system has been supplied fully programmed.

The device can now be logged on to the system. This can be achieved using the log on button or ident method. The log on button is located inside the unit.

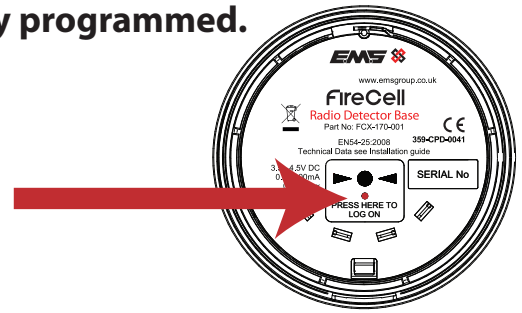

See FireCell Instruction Pack for more information

Step 6 - Install the devices

Note: When installing Combined Sounder Detectors, it is important that the tamper alignment markers are properly positioned to ensure correct operation and to prevent unnecessary tamper faults.

See FireCell Instruction Pack for more information.

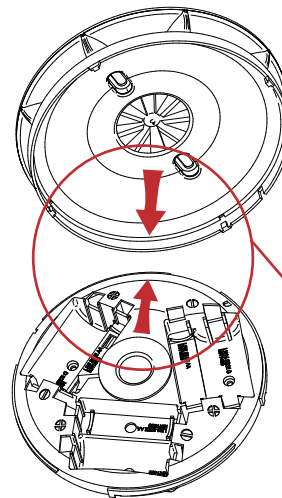

Align tamper arrows **THEN** turn to lock into place

Step 7 - Program the panel

Note: This step is not necessary if the system has been supplied fully programmed.

The Hub, RCCs and all radio devices must now be added to the panel ensuring the loop number and addresses programmed at the FireCell Hub correspond to that programmed at the panel. This can also be achieved using the Loop Explorer computer program.

See FireCell Instruction Pack for more information.

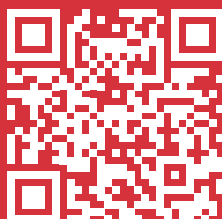

Contact us



Fire Industry Association

