

Zone Interface Module (ZIM) Installation Guide



1 Pre installation



Installation must conform to applicable local installation codes and should only be installed by a fully trained competent person.

- Ensure that the device is installed as per the site survey.
- The use of a non-metallic spacer should be considered if mounting the device on to a metal surface.
- DO NOT press the log on button on a pre-programmed device, as this will cause communication with the control panel to be lost. Should this happen, delete the device from the system and add it back on.
- This device contains electronics that may be susceptible to damage from Electrostatic Discharge (ESD). Take appropriate precautions when handling electronic boards.

2 Components

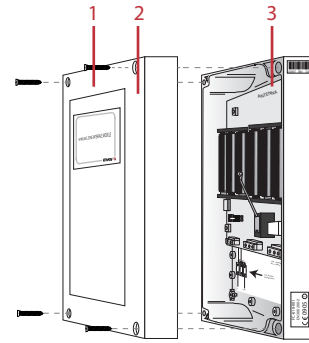

1 4x lid fixing screws, 2 Front lid, 3 Back box

3 Mounting location guidelines



For optimum wireless performance, the following must be observed:

- Ensure the ZIM is not installed within 0.6 m of the WZM.
- Ensure the ZIM is not installed within 2 m of the control panel or any other wireless or electrical equipment.
- Ensure the ZIM is not installed within 0.6 m of any metal work.

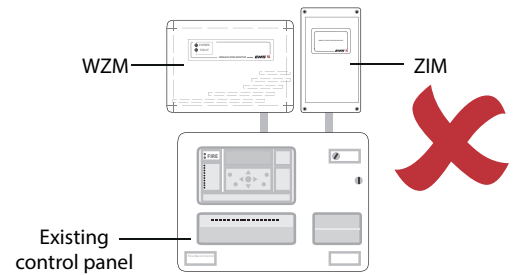
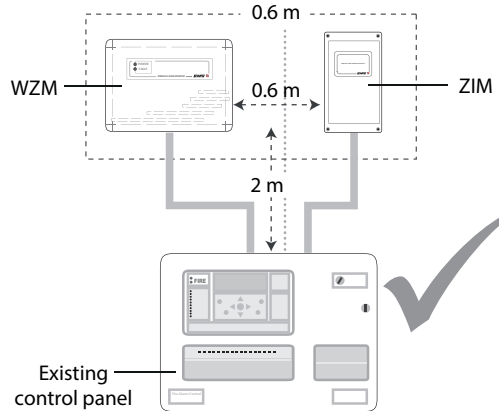

4 Remove cable entry points

- Drill the cable entry points as necessary.
- Cable glands should be used.
- DO NOT leave excess cable in the device.

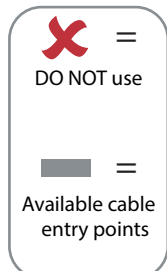
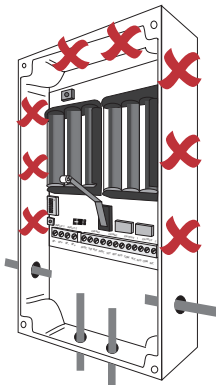

5 Fix to the wall

- Use all four circled fixing positions to ensure a firm fixing.
- Use suitable fasteners and fixings.

Fixing position location within cavity

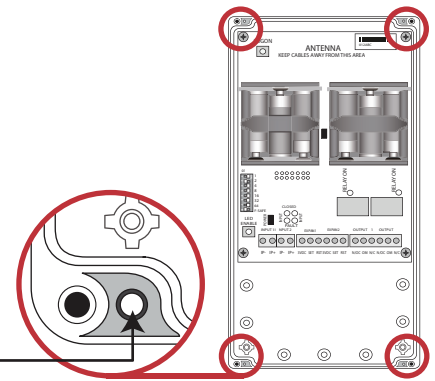

6 Connection wiring

Refer to the wireless zone monitor engineers guide (TSD143) for full wiring details.

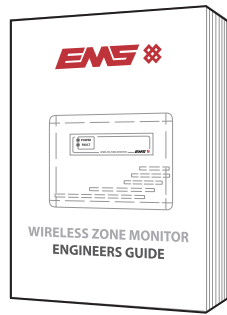

Free to download from www.emsgroup.co.uk

7 Connection wiring

- When fitting / replacing batteries; observe correct polarity, using only specified batteries.
- Connect the power jumper across the PIN header.

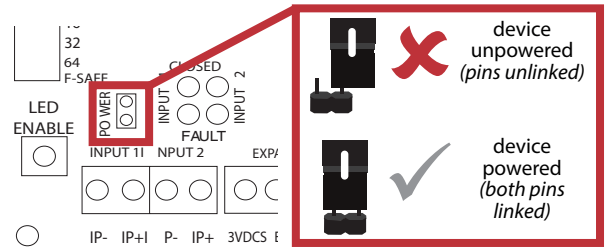

- Once powered, reassemble the device.

8 Configuration

The ZIM must be added to the WZM, before adding other wireless devices to the system.

- Refer to the wireless zone monitor engineers guide (TSD143) for full programming details.

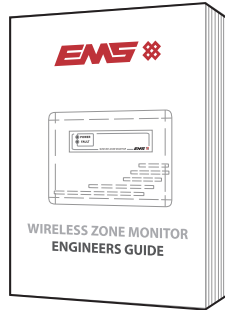

Free to download from www.emsgroup.co.uk

9 LED operation

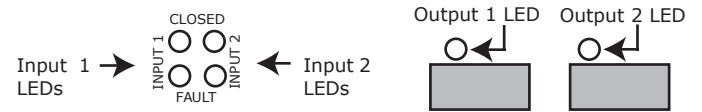

The device has six indication LEDs. Pressing the LED enable button enables their illumination for 10 minutes before automatically timing out.

2x input fault: YELLOW LED ON = FAULT

2x input closed: RED LED ON = ACTIVE

2x output: RED LED ON = ACTIVE

Specification

Operating temperature	-10 to +55 °C
Storage temperature	5 to 30 °C
Humidity	0 to 95% non-condensing
Supply	6x AA alkaline (<i>Panasonic LR6AD Powerline / Varta 4006 Industrial</i>)

CAUTION!
Fitting of an incorrect battery type invalidates the product certification and may result in poor performance.

Output rating	2A at 24 VDC
IP rating	IP65
Operating frequency	868 MHz
Output transmitter power	0 to 14 dBm (<i>0 to 25 mW</i>)
Signalling protocol	X
Dimensions (W x H x D)	120 x 240 x 60 mm
Weight	0.95 kg
Location	Type A: For indoor use

Regulatory information

Manufacturer	Carrier Manufacturing Poland Sp. z o.o. Ul. Kolejowa 24. 39-100 Ropczyce, Poland
Year of manufacture	See devices serial number label
Certification	CE 14
Certification body	0905
CPR DoP	0359-CPR-00436
Approved to	EN54-18:2005. Fire detection and fire alarm systems. Part 18:Input/output devices. EN54-25:2008. Incorporating corrigenda September 2010 and March 2012. Fire detection and fire alarm systems.
European Union Directives	EMS declares that this device is in compliance with Directive 2014/53/EU. The full text of the EU declaration of conformity is available at the following internet address: www.emsgroup.co.uk



2012/19/EU (*WEEE directive*): Products marked with this symbol cannot be disposed of as unsorted municipal waste in the European Union. For proper recycling, return this product to your local supplier upon purchase of equivalent new equipment, or dispose of it at designated collection points. For more information see www.recyclethis.info

Dispose of your batteries in an environmentally friendly manner according to your local regulations.