

FC-171-001	White Wireless Sounder Base Only	[2]
FC-171-002	Red Wireless Sounder Base Only	[2]
FC-323-CA1	White Ceiling Beacon Only	[1]
FC-323-CA2	Red Ceiling Beacon Only	[1]
FC-323-WA1	White Wall Beacon Only	[1]
FC-323-WA2	Red Wall Beacon Only	[1]

## Wireless Beacon Installation Guide

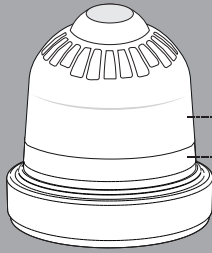

Example shown:  
FC-323-CA1  
FC-171-001

See the Specification section for compliance information.

### 1 Pre installation



Installation must conform to applicable local installation codes and should only be installed by a fully trained competent person.

- Ensure that the device is installed as per the site survey.
- The use of a non-metallic spacer should be considered if mounting the device on to a metal surface.
- Do NOT Press the Log On button on a pre-programmed device, as this will cause communication with the Control Panel to be lost. Should this happen, delete the device from the system and add it back on.
- This device contains electronics that may be susceptible to damage from Electrostatic Discharge (ESD). Take appropriate precautions when handling electronic boards.

### 2 Components

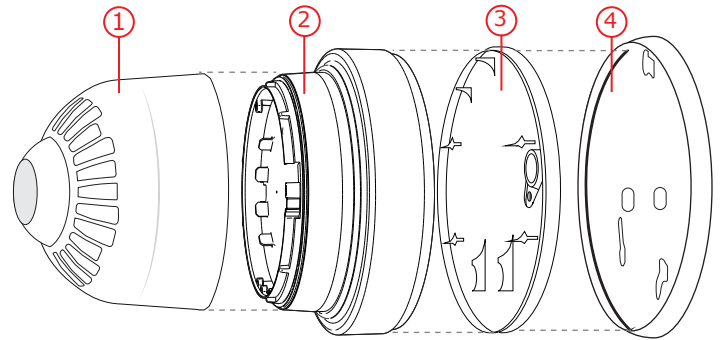

① Beacon ② Wireless module  
③ Battery retaining plate ④ Mounting plate

### 3 Fix mounting plate

Remove the mounting plate by turning the device **ANTICLOCKWISE**, to release it from the mounting plate.

- When wall mounting, ensure the mounting plate is fitted in the orientation shown.
- Use both fixing positions to ensure a firm fixing.
- Use suitable fasteners and fixings.

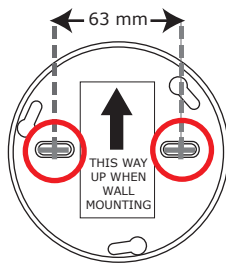
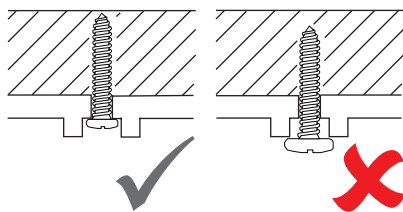

### 4 Power device

- Unclip the battery retaining plate from the wireless module.
- When fitting / replacing batteries; observe correct polarity, using only specified batteries.
- Connect the power jumper across the PIN header.

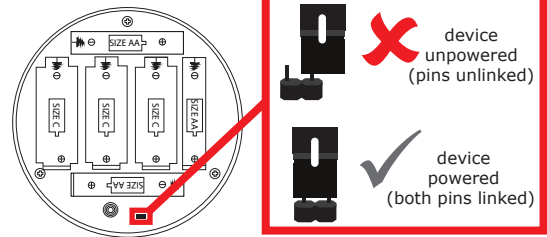

- Once powered, reassemble the device.

### 5 Optional device locking

- To lock the beacon into the wireless module, remove the cut out section as shown.

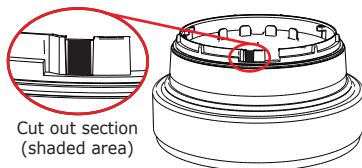

- To unlock, insert a 1.5 mm allen key to depress the locking clip and turn anticlockwise to release as shown.

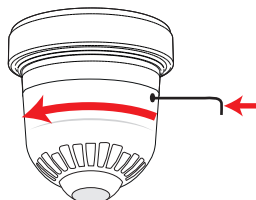

### 6 Configuration

The device's loop address is configured within the user interface's menu structure.

- Refer to the programming manual for full programming details.

FireCell = MK98  
Fusion = TSD062  
WZM = TSD143

Free to download from  
[www.emsgroup.co.uk](http://www.emsgroup.co.uk)

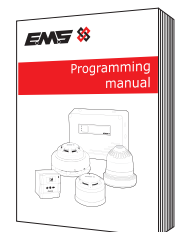

## Configuration continued

### Beacon flash rate (Set on beacon)

Switch 2 on the two way switch is used to configure the beacon flash rate. Switch 1 is not used on this product.

Default setting: 1 Hz flash rate

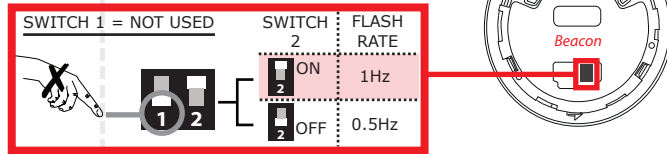

### Audio monitoring (Set on wireless module)

The device has an audio self test feature which is not used on this version of product.

Both switches should be OFF as shown.

Default setting: Audio monitoring disabled

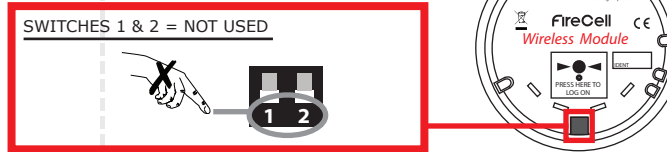

## Specification

<b>Operating temperature</b>	-10 to +55 °C
<b>Storage temperature</b>	5 to 30 °C
<b>Humidity</b>	0 to 95% non-condensing
<b>Supply</b>	3x AA alkaline (Panasonic LR6AD Powerline / Varta 4006 Industrial) 3x C alkaline (Panasonic LR14AD Powerline / Varta 4014 Industrial)
CAUTION! Fitting of an incorrect battery type invalidates the product certification and may result in poor performance.	
<b>IP rating</b>	IP54
<b>Operating frequency</b>	868 MHz
<b>Output transmitter power</b>	Auto adjusting 0 to 14 dBm (0 to 25 mW)
<b>Beacon element voltage</b>	17 to 60 VDC operating at 18 VDC
<b>Beacon element current max.</b>	40 mA at 1 Hz flash rate
<b>Flash rate</b>	0.5 Hz / 1 Hz ( <i>selectable</i> )
<b>Beacon coverage</b>	C-3-15 ( <i>ceiling mounted variant</i> ) W-3.1-11.3 ( <i>wall mounted variant</i> )
<b>Dimensions (Ø x D)</b>	120 x 145 mm
<b>Weight</b>	0.65 kg
<b>Location</b>	Type A: For indoor use

## Regulatory information

<b>Manufacturer</b>	Carrier Manufacturing Polska Sp. Z o.o. Ul. Kolejowa 24. 39-100 Ropczyce, Poland
<b>Year of manufacture</b>	See devices serial number label
<b>Certification</b>	<b>CE 14</b>
<b>Certification body</b>	<b>0905</b>
<b>CPR DoP</b>	0359-CPR-00292
<b>Approved to</b>	See part listing for associated products: EN54-23:2010. Fire detection and fire alarm systems. Part 23: Fire alarm devices. Visual alarm devices. [1]  EN54-25:2008. Incorporating corrigenda September 2010 and March 2012. Fire detection and fire alarm systems. Part 25: Components using radio links. [2]
<b>European Union directives</b>	EMS declares that this device is in compliance with Directive 2014/53/EU. The full text of the EU declaration of conformity is available at the following internet address: <a href="http://www.emsgroup.co.uk">www.emsgroup.co.uk</a>
	2012/19/EU (WEEE directive): Products marked with this symbol cannot be disposed of as unsorted municipal waste in the European Union. For proper recycling, return this product to your local supplier upon purchase of equivalent new equipment, or dispose of it at designated collection points. For more information see <a href="http://www.recyclethis.info">www.recyclethis.info</a>  Dispose of your batteries in an environmentally friendly manner according to your local regulations.