

FC-171-001	White Wireless Sounder Base Only	[2]
FC-171-002	Red Wireless Sounder Base Only	[2]
FC-323-CA1	White Ceiling Beacon Only	[1]
FC-323-CA2	Red Ceiling Beacon Only	[1]
FC-323-WA1	White Wall Beacon Only	[1]
FC-323-WA2	Red Wall Beacon Only	[1]

Wireless Beacon Installation Guide

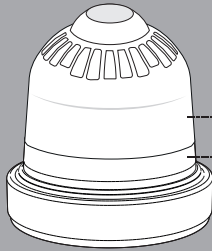

Example shown:
FC-323-CA1
FC-171-001

See the Specification section for compliance information.

1 Pre Installation



Installation must conform to applicable local installation codes and should only be installed by a fully trained competent person.

- Ensure that the device is installed as per the site survey.
- The use of a non-metallic spacer should be considered if mounting the device on to a metal surface.
- Do NOT Press the Log On button on a pre-programmed device, as this will cause communication with the Control Panel to be lost. Should this happen, delete the device from the system and add it back on.

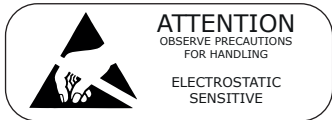

2 Components

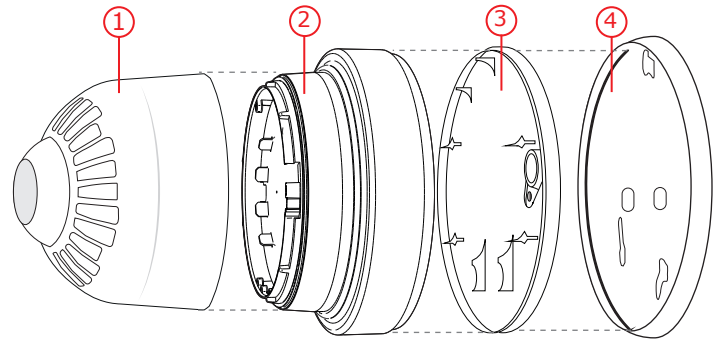

① Beacon ② Wireless Module
③ Battery Retaining Plate ④ Mounting Plate

3 Fix Mounting Plate

Remove the mounting plate from the wireless module by turning it anticlockwise.

- When wall mounting, ensure the mounting plate is fitted in the orientation shown.
- Use both mounting holes.
- Use suitable fasteners and fixings.

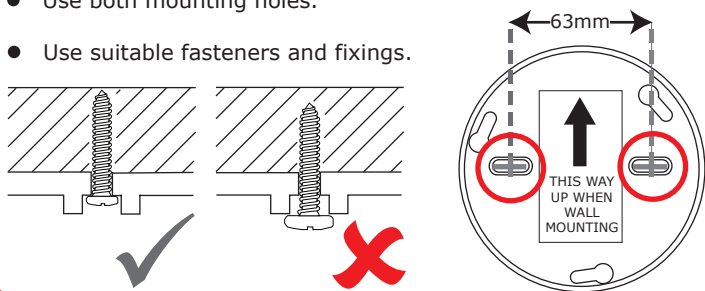

4 Power Device

- Unclip the battery retaining plate from the wireless module.
- When fitting / replacing batteries; observe correct polarity, using only specified batteries.
- Connect the power jumper across the PIN header.

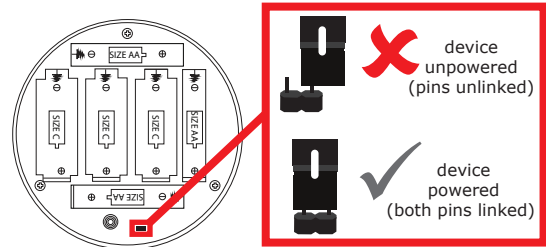

- Once powered, reassemble the device.

5 Optional Device Locking

- To lock the Beacon into the wireless module, remove the cut out section as shown.

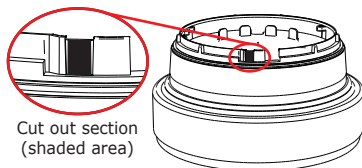

- To unlock, insert a 1.5mm Allen key to depress the locking clip and turn anticlockwise to release as shown.

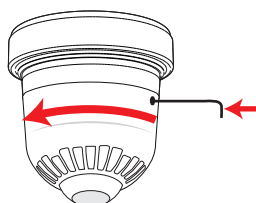

6 Configuration

The device's loop address is configured within the menu structure of the Radio Hub.

- Refer to the programming manual (Doc Ref: MK98) for full programming information.



Free to download from www.emsgroup.co.uk

Configuration Continued

Beacon Flash Rate (Set on Beacon)

Switch 2 on the two way switch is used to configure the beacon flash rate. Switch 1 is not used on this product.

Default setting: 1Hz Flash Rate

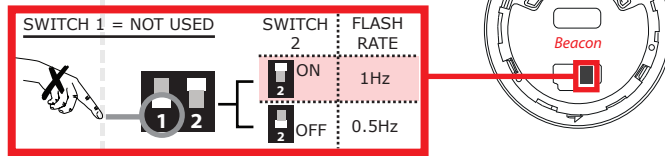

Audio Monitoring (Set on Wireless Module)

The device has an audio self test feature which is not used on this version of product.

Both switches should be OFF as shown.

Default setting: Audio Monitoring Disabled

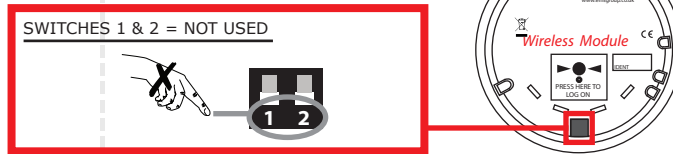

Specification

Operating Temperature	-10°C to 55°C
Storage Temperature	5°C to 30°C
Humidity	Up to 95% non-condensing
Supply	3x AA Alkaline (Panasonic LR6AD Powerline / Varta 4006 Industrial) 3x C Alkaline (Panasonic LR14AD Powerline / Varta 4014 Industrial)
CAUTION! Fitting of an incorrect battery type invalidates the product certification and may result in poor performance.	
IP Rating	IP54
Operating Frequency	868MHz
Output Transmitter Power	Auto adjusting 0 - 14 dBm (0 - 25 mW)
Beacon Element Voltage	17-60Vdc Operating at 18Vdc
Beacon Element Max Current	40mA @ 1Hz flash rate
Flash Rate	0.5Hz/1Hz (selectable)
Beacon Coverage	C-3-15 (Ceiling mounted variant) / W-3.1-11.3 (Wall mounted variant)
Dimensions	120mm (Ø) 145mm (D)
Weight	0.65kg
Location	Type A: For indoor use

Regulatory Information

Manufacturer	EMS Ltd. Technology House, Herne Bay, Kent, CT6 8JZ, United Kingdom
Year of manufacture	See devices serial number label
Certification	CE 14
Certification body	0359
CPR Certificate DOP	0359-CPR-00292
Approved to	See part listing for associated products: EN54-23:2010. Fire detection and fire alarm systems. Part 23: Fire alarm devices. Visual alarm devices. [1] EN54-25:2008. Incorporating corrigenda September 2010 and March 2012. Fire detection and fire alarm systems. Part 25: Components using radio links. [2]
European Union directives	EMS declares that the radio equipment type FireCell Beacon is in compliance with Directive 2014/53/EU. The full text of the EU declaration of conformity is available at the following internet address: www.emsgroup.co.uk
	2012/19/EU (WEEE directive): Products marked with this symbol cannot be disposed of as unsorted municipal waste in the European Union. For proper recycling, return this product to your local supplier upon purchase of equivalent new equipment, or dispose of it at designated collection points. For more information see www.recyclethis.info Dispose of your batteries in an environmentally friendly manner according to your local regulations.